

MATERIAL NUMBER	ENGINEERING NUMBER	S ±.007/.178	K REF	MATERIAL
190760001	SRA-529-06	.146/3.71	.236/5.99	BRASS
190760003	SRA-529-08	.173/4.40	.263/6.68	BRASS
190760005	SRA-529-10	.198/5.03	.288/7.32	BRASS
190760013	SRB-529-06	.146/3.71	.236/5.99	BRASS
190760015	SRB-529-08	.173/4.40	.263/6.68	BRASS
190760017	SRB-529-10	.198/5.03	.288/7.32	BRASS
190760007	SRA-S-529-06	.146/3.71	.236/5.99	STEEL
190760009	SRA-S-529-08	.173/4.40	.263/6.68	STEEL
190760011	SRA-S-529-10	.198/5.03	.288/7.32	STEEL
190760019	SRB-S-529-06	.146/3.71	.236/5.99	STEEL
190760021	SRB-S-529-08	.173/4.40	.263/6.68	STEEL
190760023	SRB-S-529-10	.198/5.03	.288/7.32	STEEL

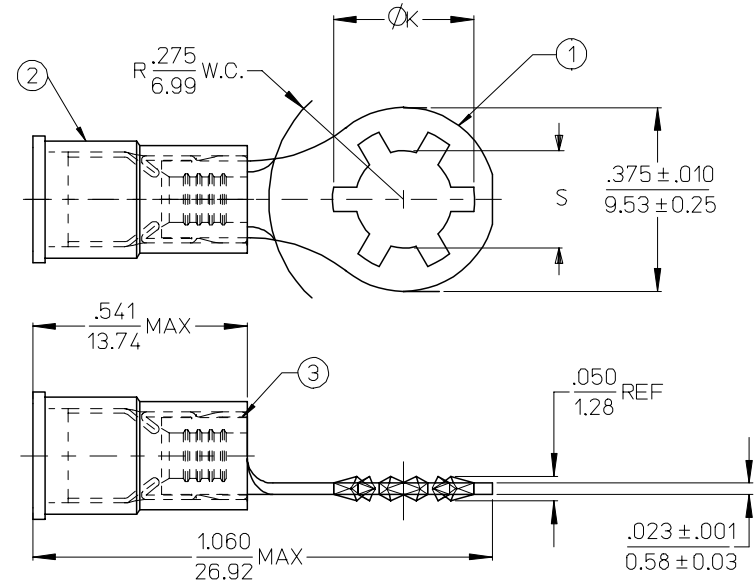

SALES DRAWING

3	1	FERRULE PLATED	BRASS	TIN PLATING
2	1	RED 600V AVIK MLD INS	NYLON	RED
1	1	STAR RING KRIMPTITE	SEE CHART	TIN PLATING
ITEM	QTY	DESCRIPTION	MATERIAL	FINISH

NOTES:

1. MATERIAL: SEE CHART
2. FINISH: SEE CHART
3. ALL COMPONENTS OF THIS ASSEMBLY ARE RoHS COMPLIANT

REVISED / REDRAWN	DESCRIPTION	QUALITY SYMBOLS	GENERAL TOLERANCES (UNLESS SPECIFIED)		DIMENSION STYLE		SCALE	DESIGN UNITS	THIRD ANGLE PROJECTION
			mm	INCH	IN/MM	INCH			
EC NO: ETC2006-0323	DRWN:ASAYDEH 2006/03/15	▽=0	4 PLACES	± --- ± ---	DRAWN BY	DATE	4:1	INCH	STAR RING TERMINAL AVIKRIMP
CHKD:RDEROSS 2006/03/22	APPR:RDEROSS 2006/03/27	▽=0	3 PLACES	± --- ± .005	CHECKED BY	DATE			
			2 PLACES	± 0.13 ± .01	ASAYDEH	06/03/15			
			1 PLACE	± 0.25 ± ---	RDEROSS	06/03/15			
				ANGULAR ±1/2°	APPROVED BY	DATE			
					RDEROSS	06/03/15			
					MATERIAL NO.	DOCUMENT NO.			
					SEE CHART	SD-19076-001			
					SIZE				
					B	THIS DRAWING CONTAINS INFORMATION THAT IS PROPRIETARY TO MOLEX INCORPORATED AND SHOULD NOT BE USED WITHOUT WRITTEN PERMISSION			